

!! CONTAINS IMPORTANT INFO, PLEASE READ IN FULL !!

Dear traders,

Trading times: 10:00-15:00.

You will find your pitch area and number on the Pitch Plan. Please check it carefully, determine which section of the market you will be trading in, and note your unload time slot.

Getting on-site

Please be aware that vehicular access to the market is **very** limited. We had a number of late arrivals to the last market, which affects the smooth set up of the whole event. **Please stick to your allocated time slot and don't be late!!** You may drive your vehicle onsite (except Town Street traders - see below) within your allocated time-slot, then you'll need to remove your vehicle, before returning to set up your stall.

All traders (except Regal Way traders) will access the market via the entrance to Great Ostry Carpark, from Rectory Road (B3136). Regal Way traders will access the market via Paul Street (A361). When you arrive, follow the signs to your trading area. You will see our wonderful stewards in purple hi-vis who are ready to help you.

Allocated unload time slots (please arrive and unload, ONLY during these times)

Market Cross

M1-M5:	7:00-7:20
M6-M13:	7:20-7:40
M14-M21:	7:40-8:00

Enter Great Ostry Carpark and follow the road around until it opens onto the Market Square. Turn left and locate your pitch.

High Street H1-H20: 8:00-8:45

Enter Great Ostry Carpark and follow the road around until it opens onto the Market Square. Follow the road to the right and locate your pitch.

Town Street T1-T20: 8:00-8:30

Town Street is fully pedestrianised, so there is no vehicular access to the street at all. There are two pedestrian entrances onto Town Street from Great Ostry Carpark. There is a loading bay that you can use whilst unloading your stock, then carry or wheel it onsite, via one of two pedestrian alleyways (check pitch plan for the alleyway closest to your pitch).

Regal Way R1-R8: 8:00-8:45

Regal Way is located to the side of the Art Bank on High Street. Access to this will be via Regal Road, off Paul Street.

Post-Market Allocated load time slots

15:00-15:45	Town Street traders load
15:45-16:15	High Street traders load
16:15-17:00	Market Cross traders load
15:00-15:45	Regal Way traders load

Electricity / Gazebos / Equipment etc

If you have requested electricity, one of our stewards will show you where to plug in. You must bring your own electrical equipment, we do not provide it. If you have booked a gazebo, it will be set up ready and waiting for you. We have no tables available, so please ensure you bring everything you need.

Carparks

Once you've unloaded your vehicle, please move it to the car park before setting up your stall. Please also note that the short-stay area of Great Ostry car park is only one hour's free parking, so don't leave your vehicle here.

Contacts

The address for the market is: Market Place, Shepton Mallet, BA4 5AZ. Emails to hello@sheptonmalletsundaymarket.org.uk will be picked up until Sat 27 July. Any issues on market day, please telephone the market manager.

Market Manager:	Charlie Bolderow	07751 950499
First Aid:	Claire Goodman	07411 189739

Don't forget to spread the word: tag us in any posts / stories and we can reshare them (@SheptonMalletSundayMarket).

Best, Charlie and the markets team.

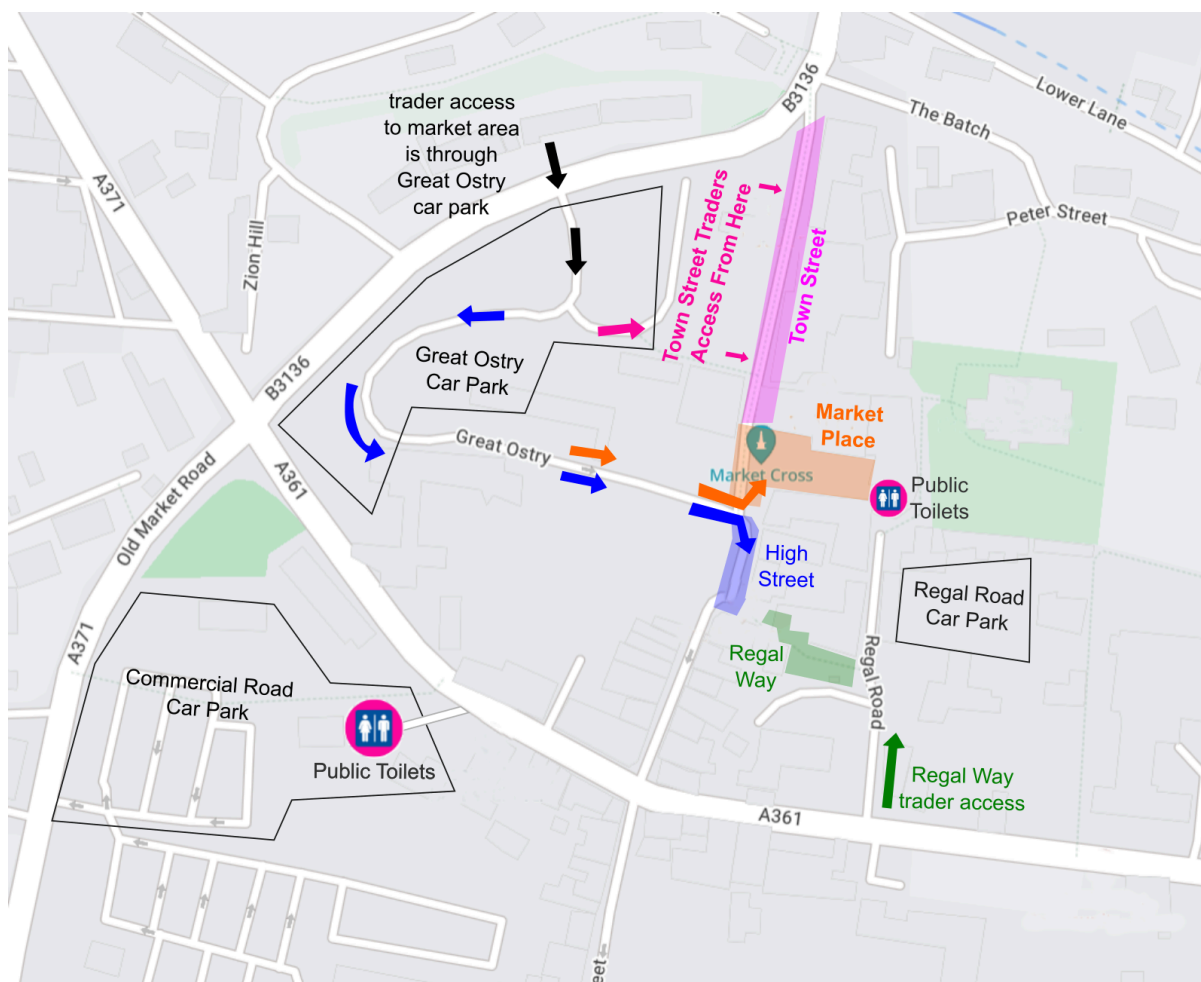

SIZE	PITCH	BUSINESS	TRADER NAME	ELEC.	VEHICLE
Town Street					
3m empty	T1	Moonshine Curiosities	Shaun Linton-Moon		
2m gazebo	T2	Horrington Handmade Soaps	Oli Draper		
2m gazebo	T3	Jessica Mae Design	Jessica Bugler		
2m gazebo	T4	Mind The Fluff	Klaudia Mrugala		
2m gazebo	T5	Hibi Botanics	Rose Drysdale		
2m gazebo	T6	Bethan Mary Clarke	Bethan Clarke		
2m gazebo	T7	jpgpottery	Jane Thomas		
2m empty	T8	Tula and the Whale	Kat Hoey		
	T9	- Create @#8	-		
2m gazebo	T10	Tales of Ro	Rowena Draper		
2m gazebo	T11	H.Petitpois Design ltd	Heloise Motte		
2m gazebo	T12	Emma Chapman Pottery	Emma Chapman		
2m empty	T13	Ginger Pink Yarns	Kerry Moyle		
2m gazebo	T14	Lost Isle Project	Katy Wyatt		
2m gazebo	T15	The Sustainable Shop	Claire Gabe		
2m gazebo	T16	Shepton Mallet Snowdrop Fest	Angela Morley		
2m gazebo	T17	Alice Hawkins Art	Alice Hawkins		
2m gazebo	T18	Two Tone Rebel	Joscelin Platt		
2m empty	T19	Hebe Designs	Hebe Chant		
2m empty	T20	Gaganis	Izabela Gkagkanis		
Market Place					
6m empty	M1	Westcombe Dairy	Karina		
3m empty	M2	Muti (Fermental Ltd)	Matt White		
3m empty	M3	Sean The Chef	Sean Boyle		
3m empty	M4	Squeeze & Go	Joanne & Patrick Lapper	E	/
3m empty	M5	Pizza My Heart	Laura Humphreys	E	/
3m empty	M6	Brickell's Ice Cream	Iona Gore	E	/
3m empty	M7	Woodshedding Brewery	Tommy Peck	E	
3m empty	M8	Shorkk Ltd	Miranda el Khazen		
3m empty	M9	Two Trees Cider & Perry	Brett St Clair		
3m empty	M10	Cotton Lily	Katie Wales		
3m empty	M11	Thomas D'Arcy - The Garden H	Kris Hellard		
3m empty	M12	Cheeky Bean	Steven Piper		
3m empty	M13	Still Sisters	Ellie Robinson		
3m empty	M14	Mahalia's Kitchen	Mahalia Purchase	E	
3m empty	M15	White Lake Cheese	Jacqui Hobbs		
3m empty	M16	Rutab	Ross Cains		
3m empty	M17	Nestcake Caravan	Vix Ross		
2m empty	M18	The Midnight Garden	Beth Litaunieks		
3m empty	M19	Moist	James Macfarlane		
3m empty	M20	Black Bee Honey	Paul Webb		
3m empty	M21	Four Legged Fancies	Victoria Rough		

High Street					
2m gazebo	H1	B's Bees	Bridget Grady		
2m gazebo	H2	HDMini	Holly Dart		
2m gazebo	H3	The Last Drop	Kelly Moger		
2m gazebo	H4	Vintage Doodahs Ltd	Jules Webb		
2m gazebo	H5	GingerBeard's Preserves	Clare Charras		
2m gazebo	H6	Honey Coast Studio	Harriet Cradick		
2m gazebo	H7	Mogsta	Tom Makin		
2m gazebo	H8	Japonica	Anna Parkinson-Bates		
3m empty	H9	Milly's vintage and crafts	Rachel Allen		
3m empty	H10	Lamina Bakery	Rebecca Cross		
3m empty	H11	LOFT	Maggie Stonar		
3m empty	H12	The Lowdown Store	George Francis		
3m empty	H13	Held Home	Jessica Francis		
3m empty	H14	Meadow In My Garden	Paul Jupp		
3m empty	H15	JP Woodworking	Phil White		
3m empty	H16	Somerset Wildlife Trust	Charlotte Guy		
3m empty	H17	Essence & Bloom Gift Co	Stephanie Cullen		
3m empty	H18	LB Pet Care Services	Lisa Burr		
3m empty	H19	Hidden Treasure	Abi Madamedon		
3m empty	H20	Working For Wildlife	James Kazer		
2m empty	H21	The Record Room	Jonathan Ralfe		
Regal Way					
SIZE	PITCH	BUSINESS	TRADER NAME		
2m gazebo	R1	At Number 19	Katie Gillard		
3m empty	R2	Quantum Illustration	Emma Fallon		
2m empty	R3	-	-		
6m x 1m	R4	Anna's Attic	Anna Olszewska		
3m empty	R5	Wolfe Academy	Oly Hillier-Rundle		
3m empty	R6	Old Green	Tori Fallesen		
3m empty	R7	Foraged Steel	Charlotte Smith		
3m empty	R8	Shepton Mens Shed	Peter Nash		

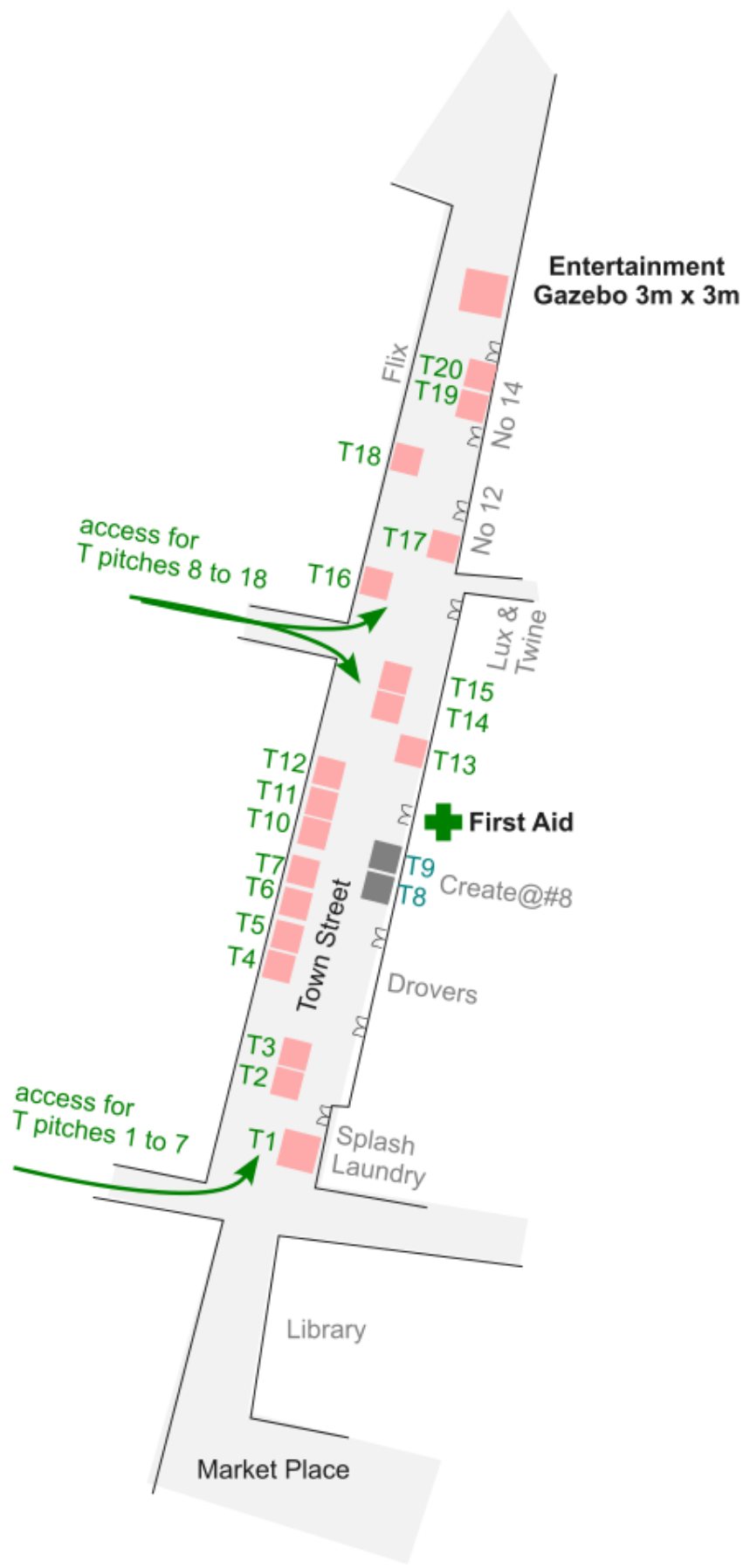

Entertainment Gazebo 3m x 3m

Flix

T20

T19

No 14

T18

No 12

access for T pitches 8 to 18

T16

T17

No 12

Lux & Twine

T15

T14

T13

First Aid

T9

T8

Create@#8

Town Street

Drovers

T7

T6

T5

T4

T3

T2

T1

Splash Laundry

access for T pitches 1 to 7

Library

Market Place

